

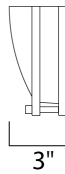

PRODUCT DESCRIPTION

Linear EE collection's commercial grade energy efficient lighting features linear frames of metal finished in Satin Nickel and White acrylic diffusers. High Power Factor ballasts allow for commercial applications and the fluorescent light source ensure low maintenance and energy cost savings. Specific styles of Linear EE are also available with a LED light source in the Linear LED collection.

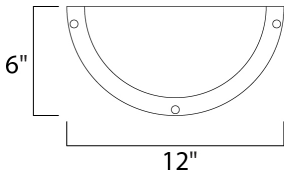

MEASUREMENTS

DIMENSION : 12." W x 6." H x 3." Ext
 HANGING WEIGHT : 1.1 lb

LAMPING

INPUT VOLTAGE : 120V
 LUMENS : 900 Rated (0 Del.)
 BULB : 1 x 13W (INCLUDED), 13W Total
 COLOR_TEMP : 2700K

FINISHES OPTION

Satin Nickel SN



GLASS

White WT

MATERIAL

Die Cast Aluminum

RATINGS

Dry Location
 CA Title 24



ADDITIONAL

INSTALL UP/DOWN:
 OPERATING TEMPERATURE:
 -20°C (-4°F), 40°C (104°F)

Always consult a qualified electrician before installing any lighting product.



WESTERN DISTRIBUTION CENTER (HEADQUARTER)
 253 NORTH VINELAND AVE | CITY OF INDUSTRY, CA 91746

EASTERN DISTRIBUTION CENTER
 4200 SHIRLEY DR. | ATLANTA, GA 30336

P. 626.956.4200 | F. 626.956.4225 | maximlighting.com